

TRANSFUSION MEDICINE SERVICES

CLASSIFICATION Coagulation Factor XIII Plasma Derived Product	ALERTS None
---	-----------------------

PREPARATION and ADMINISTRATION

Corifact is a plasma derived factor concentrate, blood consent IS required.

Reconstitution

Diluent: sterile water for injection (4 or 20 mL, depending on dose)

See pages 3–5 for reconstitution steps –administer within 4 hours of reconstitution

After reconstitution, inspect visually for particulate matter prior to administration

IV Direct	Intermittent Infusion	Continuous Infusion
<p>IV Direct is the recommended route of administration. Professionals performing these restricted activities must have received authorization from their regulatory College and have the knowledge and skill to perform the skill competently</p> <p>Administer dose as reconstituted solution at rate not to exceed 4 mL/min, if patient is tolerating well If no indwelling IV, use the butterfly and supplies provided in the box.</p>	IV Bag (large volume pump)	IV Bag (large volume pump)
	Not Recommended	Not applicable
	Syringe (syringe pump)	Syringe (syringe pump)
	Not Recommended	Not applicable

Requirements and Monitoring

Baseline vitals before starting infusion. Reassess 15 min after infusion.

Document all vitals taken.

Blood pressure via cuff or arterial line

Temperature

Heart Rate

Respirations

Keep unopened back up bag of NS and standard IV tubing nearby for prompt response if an adverse event (AE) occurs.

INDICATIONS

Indicated in adults and children with congenital Factor XIII deficiency for:

- Routine prophylactic treatment
- The control of bleeding episodes
- Peri-operative management of surgical bleeding

TRANSFUSION MEDICINE SERVICES

CLASSIFICATION Coagulation Factor XIII Plasma Derived Product	ALERTS None
---	-----------------------

ADVERSE EFFECTS

The most common adverse reactions reported following Corifact treatment are joint inflammation, hypersensitivity, rash, pruritus, erythema, hematoma, arthralgia, headache, elevated thrombin-antithrombin levels, and increased blood lactate dehydrogenase.

The most serious adverse reactions were hypersensitivity, acute ischemia, and neutralizing antibodies against FXIII.

If an AE is suspected: stop the infusion and consult the authorized prescriber (AP) for medical management. Notify the TM lab of a suspected reaction.

- Review the product lot number, TM tag and patient ID to rule out a verification (clerical) error and that the expiry date and time has not passed.
- Resume infusion cautiously as directed by AP. Directly observe patient x5min then closely observe x10min.
- Ensure TM tag, along with a copy of the documented clinical data and interventions are sent to TM lab once infusion is discontinued or completed.

DOSAGE

Consult the Bleeding Disorders Clinic or the Hematologist on call for appropriate dosing prior to initial dose:

Ask patient if they have a Factor First card supplying the recommended treatment and dosage

(Adult) Hereditary Bleeding Disorder Clinic 902-473-5612. After hours call 902-473-2220.

(Pediatric) IWK Bleeding Disorder Clinic 902-470-8752. After hours call 1-888-470-8888.

For patient specific dosing at the IWK please see Complex Care Management Plan in the “Alerts” section under “Scanned Permanent Health Records” in the IWK MEDITECH MAGIC system.

COMPATIBILITY, STABILITY

- Compatible with NS
- Single use vials. Do not use past expiry date
- Do not dilute in any IV solutions
- Prior to reconstitution, vials should be stored in their supplied box to protect from light
- Do not store unused vials in refrigerator. Administer at room temperature

DOSAGE FORMS

- Supplied by Transfusion Medicine (Blood Bank)

MISCELLANEOUS

- None

TRANSFUSION MEDICINE SERVICES

<p>CLASSIFICATION Coagulation Factor XIII Plasma Derived Product</p>	<p>ALERTS None</p>
---	-------------------------------

RECONSTITUTION

1. Bring the Corifact vial and diluent vial to room temperature. Don clean gloves.
2. Place the Corifact vial, diluent vial and Mix2Vial® transfer set on a flat surface.
3. Remove Corifact vial and diluent vial flip caps and wipe the stoppers with an antiseptic. Allow to dry prior to opening the Mix2Vial® transfer set package.

4. Open the Mix2Vial® transfer set package by peeling away the lid (Fig. 1). To maintain sterility, leave the Mix2Vial® transfer set in its clear outer package.



Fig. 1

5. Place the diluent vial on an even flat surface and hold the vial tightly. Grip the Mix2Vial® transfer set keeping it in the clear package and push the plastic spike of the blue end of the Mix2Vial® transfer set firmly through the center of the diluent vial stopper (Fig. 2).



Fig. 2

6. While holding the diluent vial, carefully remove the outer package from the Mix2Vial® transfer set. Make sure to pull off only the clear package, not the Mix2Vial® transfer set (Fig. 3).



Fig. 3

7. Place the Corifact vial on an even flat surface and hold the vial tight. Invert the diluent vial with the Mix2Vial® transfer set attached to it and push the plastic spike of the clear end of the Mix2Vial® firmly through the center of the stopper of the Corifact vial (Fig. 4). The diluent will transfer into the Corifact vial automatically.



Fig. 4

TRANSFUSION MEDICINE SERVICES

CLASSIFICATION Coagulation Factor XIII Plasma Derived Product	ALERTS None
---	-----------------------

8. With the diluent and Corifact vial still attached to the Mix2Vial® transfer set, gently swirl the Corifact vial to ensure that the Corifact is fully dissolved (Fig. 5). **Do not shake the vial.**



Fig. 5

9. With one hand, grip the clear end of the Mix2Vial® transfer set and with the other hand grip the blue end of the Mix2Vial® transfer set, and unscrew counterclockwise the set into two pieces. (Fig. 6).

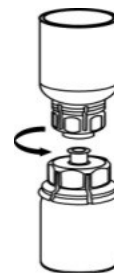

Fig. 6

10. Draw air into an empty, sterile syringe. With the Corifact vial upright, screw the syringe to the Mix2Vial® transfer set. Inject air into the Corifact vial. While keeping the syringe plunger pressed, invert the Corifact vial and draw the solution into the syringe by pulling the plunger back slowly. (Fig. 7).



Fig. 7

11. Once the solution has been transferred into the syringe, firmly grip the barrel of the syringe (keeping the plunger facing down) and unscrew the syringe counterclockwise from the Mix2Vial® transfer set (Fig. 8). Attach the syringe to an infusion set or another suitable administration set.



Fig. 8

TRANSFUSION MEDICINE SERVICES

CLASSIFICATION Coagulation Factor XIII Plasma Derived Product	ALERTS None
---	-----------------------

12. The contents of multiple vials can be drawn up in the same syringe.
Use a separate unused Mix2Vial® transfer set for each product vial.

REFERENCES

- [CL-BP-030, IWK-625 Blood Component and Blood Product Administration – Policy and Procedure](#)
- Corifact product monograph. Found at <https://www.cslbehring.ca/products/product-list>